

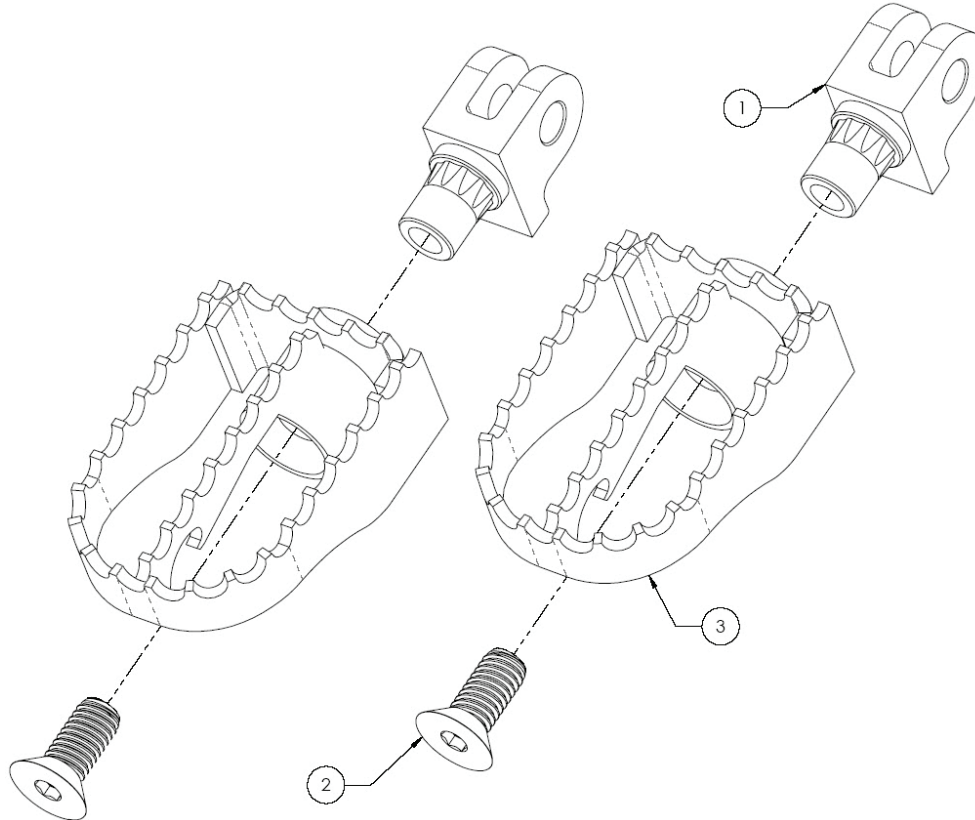

Installation Instructions BURLY FOOT PEGS

Kit Parts Diagram



Item No.	Description	QTY.
1	PEG MOUNT (STYLE MAY VARY)	2
2	SCREW, 7/16 FSH	2
3	FOOT PEG (STYLE MAY VARY)	2

WARNINGS & ALERTS

- The operator must use extreme caution when operating a modified motorcycle, particularly while getting familiar with its altered features.
- Read and follow all instructions to properly install this kit.
- Improper installation can cause unsatisfactory and / or unsafe operation.

INSTALLATION INSTRUCTIONS BURLY FOOT-PEGS

- Turn off your motorcycle and place securely on a lift or motorcycle jack.
- Unbolt and remove your current pegs by removing the retaining ring and pin. Retain all factory springs and hardware. Some passenger peg models may have a spring loaded ball detent. The spring may shoot the ball out during peg removal. Protective eyewear is required.

**** Be careful not to lose ball during removal ****

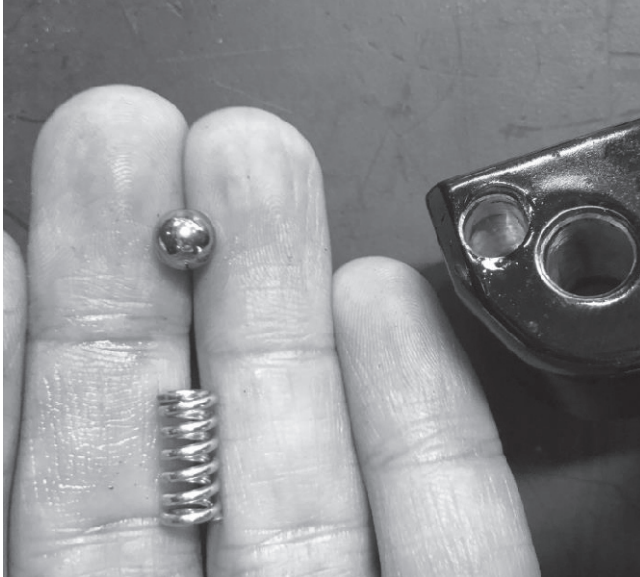

NOTE: Refer to Manufacturer service manual for additional instructions.

- **Rider Peg Installation** - Reusing the factory torsion spring, install spring onto the clevis peg mount and peg mounting bolt.

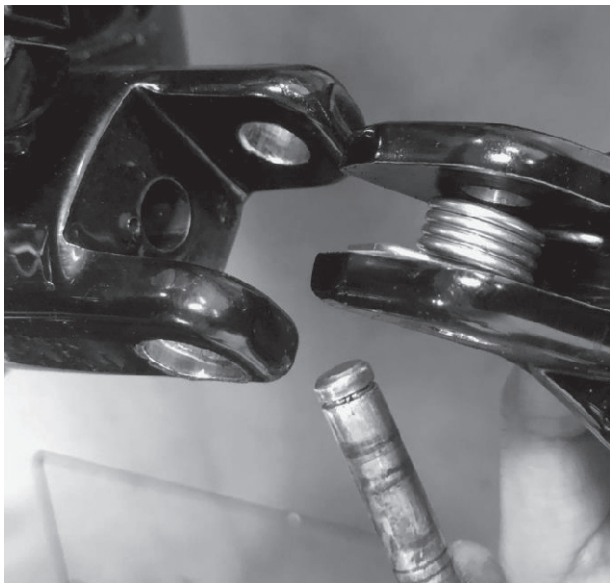

Align peg mounting bolt holes, clevis peg mount and torsion spring. Insert pin and secure with retaining ring.

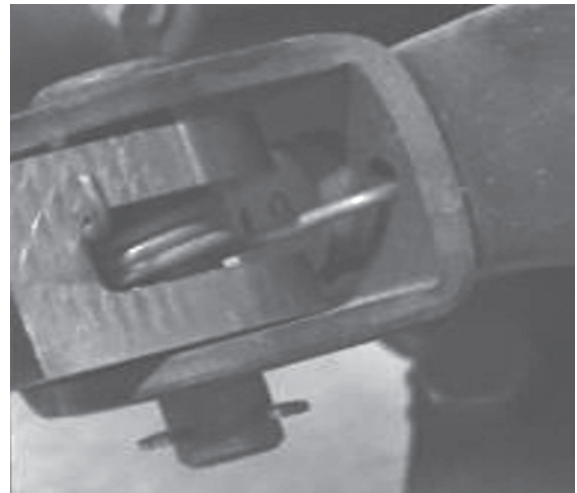

Install Peg using supplied 7/16" FSHS Screw.

WARNING: DO NOT TIGHTEN SCREW UNTIL DESIRED FOOT PEG ORIENTATION IS FOUND

Lightly screw in the supplied 7/16 FSHS screw but DO NOT TIGHTEN. Sit on the bike to ensure the peg is oriented at the desired position before tightening the screw to 20-30 ft-lbs. Once tightened, the peg will be wedged onto the mount which eliminates spinning.



- **Passenger Peg Installation** - Reusing the factory compression spring and ball, install spring and ball onto the peg mounting bolt. Using pliers to pinch the ball into peg mounting bolt may allow the peg to go into the clevis peg mount easier.

INSTALLATION INSTRUCTIONS BURLY FOOT-PEGS (continued)

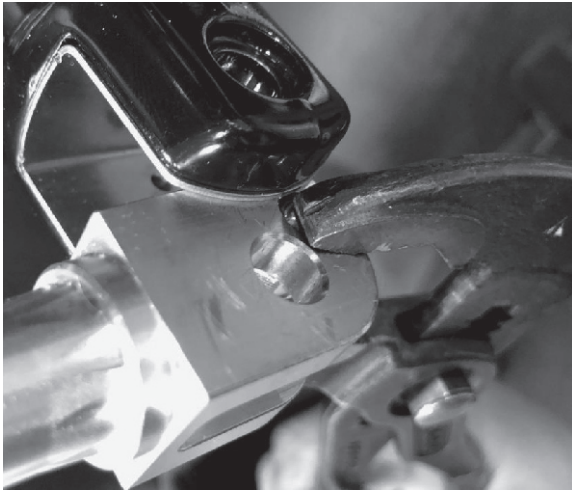

For Models containing an inner sleeve in the clevis peg mount, remove the sleeve from the clevis peg mount before installing the peg mounting bolt. This may ease the installation of the ball and compression spring into the clevis peg mount. Align holes and insert Pin and retaining ring.



Install Peg using supplied 7/16" FHSW Screw.

WARNING: DO NOT TIGHTEN SCREW UNTIL DESIRED FOOT PEG ORIENTATION IS FOUND

Lightly screw in the supplied 7/16 FHSW screw but DO NOT TIGHTEN. Sit on the bike to ensure the peg is oriented at the desired position before tightening the screw to 20-30 ft-lbs. Once tightened, the peg will be wedged onto the mount which eliminates spinning.

NOTE: In the event the pegs need to be adjusted or removed, the entire foot peg assembly must be removed from the bike. Wrap the Pegs to protect it from scratches and clamp the Peg to a vice. Partially remove the screw about half way and use a rubber mallet to gently tap the screw until the peg is free from the clevis mount.

- Test and check Pegs to ensure proper functionality before hitting the road.

LIMITED GUARANTEE

We continually inspect and try to improve our products. All parts have been inspected prior to packaging, and our guarantee is limited to replacement of defective parts. This guarantee is in lieu of all guarantees or warranties implied or expressed. Because we cannot control the application of our products, buyer assumes risks for any and all damage caused by himself or third party, by virtue of failure of these parts. We make no warranty as to products distributed by us, expressed or implied, including without limitation any warranties or merchant ability and fitness for a particular purpose. We will however, pass on all warranties made by the manufacturer, who has sole responsibility for performing such warranties. The manufacturer shall solely be responsible for any damage to person or property arising from design, manufacturing and testing of all products, and we accept no liability for such damages. We shall not be liable for indirect or consequential damages.