

INSTALLATION INSTRUCTIONS

BURLY FAIRING

KIT CONTENTS

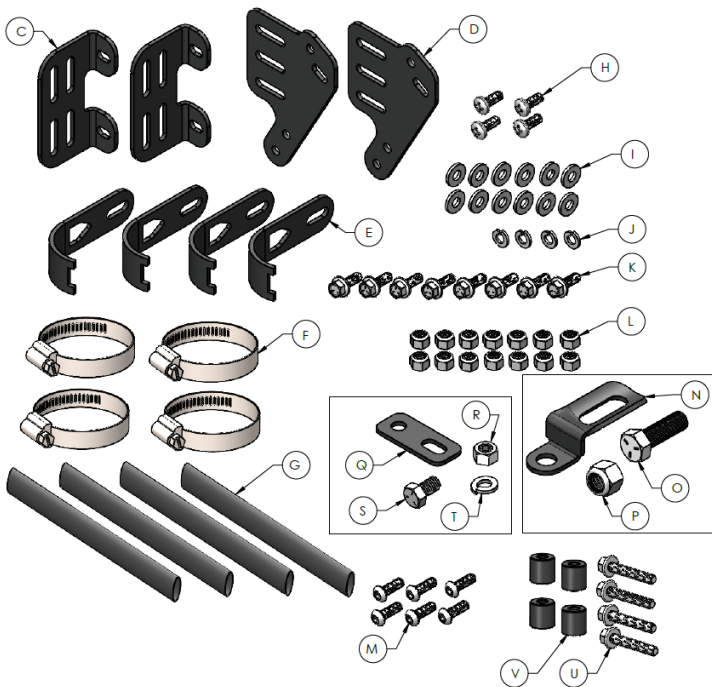

PART	DESCRIPTION	QTY
A	FAIRING	1
B	WINDSHIELD (CLASSIC CAFÉ & CLUB ONLY)	1
C	FAIRING BRACKET	2
D	ADJUSTMENT BRACKET	2
E	FORK BRACKET	4
F	HOSE CLAMPS	4
G	HEAT SHRINK TUBING	4
H	SOCKET CAP SCREW	4
I	FLAT WASHER	8
J	SPLIT LOCK WASHER	4
K	FLANGE HEX BOLT	8
L	NYLOCK NUT 1/4-20	14
M	BUTTON HEAD CAP SCREW	6
U	SOCKET CAP SCREW, L-1.5"	4
V	SPACER	4
TOP MOUNT HEADLIGHT RELOCATION HARDWARE		
N	TOP MOUNT HEADLIGHT BRACKET	1
O	HEX BOLT 1/2-20 X 1	1
P	NYLOCK NUT 1/2-20	1
FORTY-EIGHT MODEL HEADLIGHT RELOCATION HARDWARE		
Q	FORTY-EIGHT HEADLIGHT BRACKET	1
R	NUT 3/8-16	1
S	HEX BOLT 3/8-16 X 0.63"	1
T	SPLIT LOCK WASHER 3/8"	1

LIMITED GUARANTEE

We continually inspect and try to improve our products. All parts have been inspected prior to packaging, and our guarantee is limited to replacement of defective parts. This guarantee is in lieu of all guarantees or warranties implied or expressed. Because we can not control the application of our products, the buyer assumes risks for any and all damage caused by themselves or any third party, by virtue of failure of these parts. We make no warranty as to products distributed by us, expressed or implied, including without limitation, any warranties or merchant ability and fitness for particular purpose. We will, however, pass on all warranties made by the manufacturer, who has sole responsibility for performing such warranties. The manufacturer shall solely be responsible for any damage to person or property arising from design, manufacturing and testing of all products, and we accept no liability for such damages. We shall not be liable for indirect or consequential damages.

INSTALLATION INSTRUCTIONS

BURLY FAIRING

WARNINGS & ALERTS:

- SOME MODIFICATION AND OR RE-ROUTING OF CABLES MAY BE REQUIRED FOR BEST FIT DEPENDING ON YOUR APPLICATION.
- ONCE THE FAIRING IS INSTALLED, BE CERTAIN THAT IT DOES NOT INTERFERE WITH ANY OF THE CONTROLS OR STEERING OF THE MOTORCYCLE THROUGHOUT THE FULL RANGE OF MOTION (LOCK TO LOCK).
- INSTALLATION HARDWARE INCLUDED IS INTENDED FOR SEVERAL DIFFERENT MODELS, SOME APPLICATIONS MAY NOT USE ALL THE INCLUDED HARDWARE.
- MAY FIT ADDITIONAL MODELS WITH SOME MODIFICATION.
- WINDSHIELDS ARE NOVELTY ITEMS AND NOT DOT APPROVED.
- READ AND FOLLOW ALL INSTRUCTIONS TO PROPERLY INSTALL THIS KIT!

1. If applicable, assemble fairing and windshield using parts (M) and (L). Torque hardware to 5in lbs.
2. If applicable install headlight relocation bracket. Refer to manufacturer's manual for torque specifications. See Figure 1 for top mount headlight relocation reference. See Figure 2 for Forty-Eight model headlight relocation reference.
3. (Optional) Apply heat shrink tubing (G) to hose clamps, See Figure 3. Fit hose clamp (F) and fork bracket (E) onto upper fork. Measures the length of the hose clamp to be covered with heat shrink tubing. Cut heat shrink tubing to desired length. Remove hose clamp from fork. Apply heat shrink tubing to hose clamp using a heat gun. Cut and apply heat shrink tubing to remaining hose clamps.
4. Install fairing bracket (C) onto fairing using (H) and (J). See Figure 4,5,6 & 8 for recommended configurations for your application. Torque hardware to 2 ft. lbs.
5. Install fork brackets (E) with hose clamps (F) onto upper fork. Keep hose clamps loose enough so that brackets can easily be positioned. Do not tighten fully until fairing is in desired position. See Figure 4,5,6 & 8 for recommended configuration for your application.

Figure 1



Figure 2

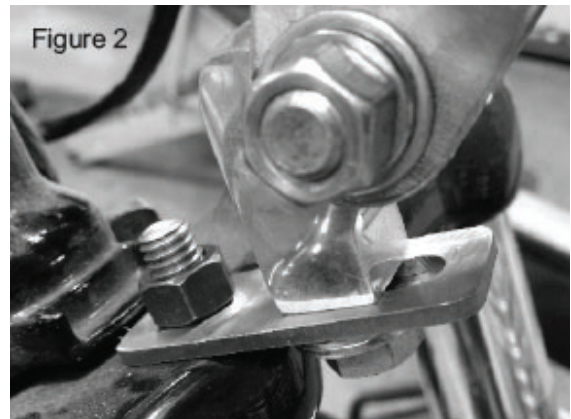

Figure 3



INSTALLATION INSTRUCTIONS

BURLY FAIRING

Figure 4 (XL)

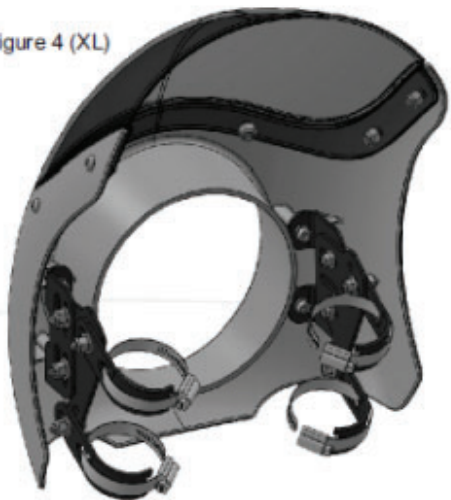

Figure 5 (Dyna)

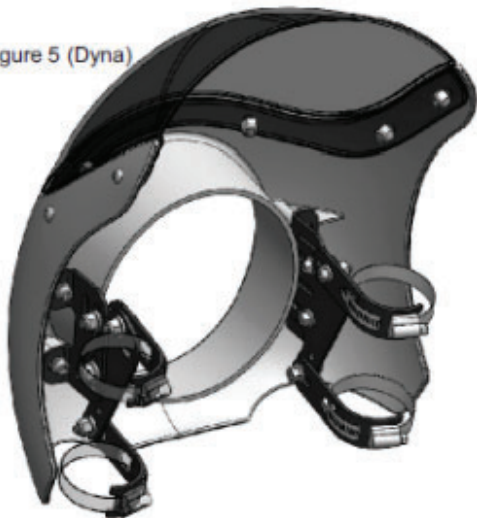

Figure 6 (48)



6. Place fairing around the headlight allowing the headlight to sit inside the headlight bucket, see Figure 7. If headlight does not fit inside the headlight bucket, position fairing so there is a 1/8" gap between the headlight and the headlight bucket opening. Align adjustment brackets (D) with fairing brackets (C) and fork brackets (E). Install adjustment brackets (D) using (K) (I)&(L) or (U)(V)(I)&(L). See Figure 4,5,6 & 8 for suggested configuration for your application.
7. Adjust fairing into desired position. Torque adjustment bracket hardware (K or U,I,L) to 5 ft. lbs. Torque hose clamps (F) to 20-25 in. lbs. Verify fairing is not touching headlight. If it is,

Figure 7

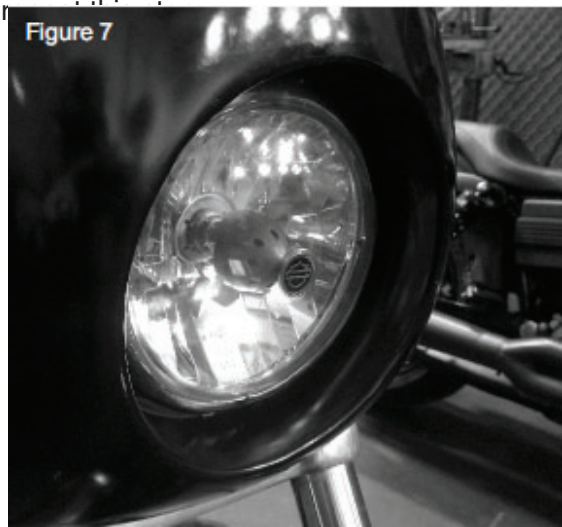

Figure 8 (Honda Rebel)



BURLY BRAND
MOTORCYCLE  ACCESSORIES